

## For swing gates with leafs up to 5 m.

Electromechanical gearmotor for external assembly. Available also in 24 Vdc version, with magnetic encoder. Ideal for all requirements from residential to industrial applications. New functional design and exclusive style.

### New third generation models:

quality and durability thanks to the housing, made up of two tough aluminium shells with polyester paint finish; more resistant to atmospheric agents.

Internal moving parts completely in steel, light alloys and technopolymers.

**Reliable and silent:** patented layout or internal parts.

**Bronze lead** screw for safe closure.

**Simple installation and maintenance,** with built-in capacitor.

**Generously sized and practical connection compartment:**

rapid and easy access from above to internal parts located in the upper section of the motor.

**Total interchangeability with the series Moby5000:** identical positions and fixing brackets.

### Recommended control units:

Mindy A3, A3F, A6, A6F, A60, A700F; for TO5024 and TO5024I Mindy A824T.

**24 Vdc version** with magnetic encoder, perfect for intensive use (for TO5024I only):

- simple programming of functions, by means of a single key
- clutch with anti-crush safety mechanism
- memorisation of limit positions on opening and closing in self-learning mode
- programming of pause time; pedestrian pass door, deceleration on opening and closing
- operation in the event of a power failure by means of rechargeable batteries

100%  
new!

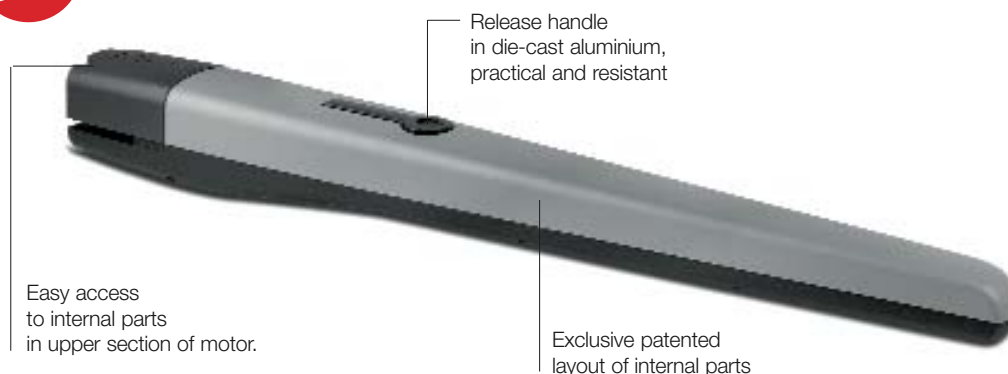

Code	Description	Pack/pallet
<b>TO5024</b>	irreversible, 24 Vdc, with magnetic encoder, mechanical stop in opening	20
<b>TO5024I</b>	irreversible, 24 Vdc, with magnetic encoder, mechanical stop in opening; for intensiv use	20
<b>TO5015</b>	irreversible, 230 Vac, slow, with limit switch in opening	20
<b>TO5016</b>	irreversible, 230 Vac, slow, with limit switch in opening and closing	20
<b>TO5605</b>	reversible, 230 Vac, fast, with limit switch in opening	20

Technical specifications		TO5024	TO5024I	TO5015	TO5016	TO5605
Power	(Vac 50 Hz)	-		230		
	(Vdc)	24		-		
Max. absorption	(A)	5		1.5	1.3	
Nominal absorption	(A)	2	2.5	1	0.9	
Max. absorbed power	(W)	120		340	300	
Nominal absorbed power	(W)	60		180	160	
Built-in capacitor	(µF)	-		7		
Protection level	(IP)	44				
Speed under no load	(m/s)	0.016	0.013		0.016	
Speed under load	(m/s)	0.012	0.010		0.012	
Travel	(mm)	540		505	540	
Max. force	(N)	1800				
Nominal force	(N)	600				
Working temp.	(°C Min/Max)	-20 ÷ +50				
Thermal cut-out	(°C)	-		140		
Work cycle	(cycle/hour)	24	45	22	19	
Insulation class		A		F		
Dimensions	(mm)	965x115x105 h				
Weight	(kg)	7	8	7		

Utilisation limits

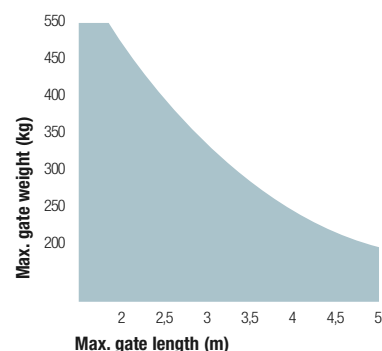

The shape, the height of the gate and the weather conditions can considerably reduce the values shown in the graph to the side. Use in windy areas 230 Vac models.

# Nice Toona5

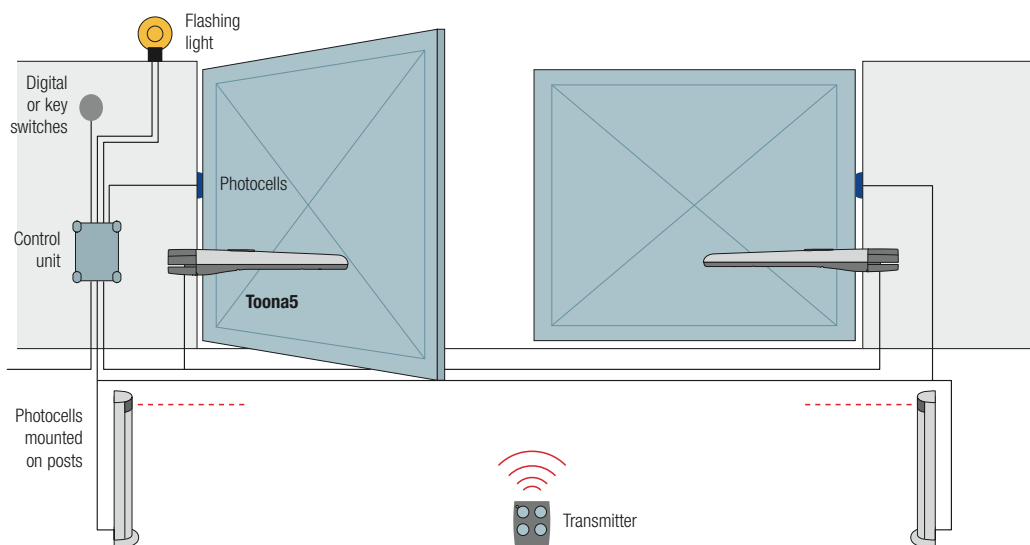

## Accessories



**PLA6**  
rear bracket  
250 mm long  
Pc./pack 1



**PLA8**  
screw-adjustable  
front bracket  
Pc./pack 1



**PLA10**  
vertical 12 V electric lock  
(required for gates longer  
than 3 m)  
Pc./pack 1



**PLA11**  
horizontal 12 V electric lock  
(required for gates longer  
than 3 m)  
Pc./pack 1



**PLA13**  
mechanical travel stops for  
closing and opening  
manoeuvres  
Pc./pack 4



**TS**  
signboard  
Pc./pack 1  
€ 2,50

## Accessories for T05024 and T05024I



**CARICA**  
plug-in card  
for battery charger  
Pc./pack 1



**B12-B**  
12 V 6 Ah batteries  
Pc./pack 1



**B12V-C**  
12 V 2 Ah batteries  
Pc./pack 1



**BA3-A**  
Nice box for batteries